

CYCLONE ASSEMBLY COMPONENTS
Comprising of self drilling screw & one piece cyclone washer
METAL DRILLING SCREW WITH BRA WASHER
CYCLONE ASSEMBLY

FOR SELF DRILLING INTO STEEL PURLINS
14-10x50/65mm
(HEAD MARKING B4 & BF ONLY)

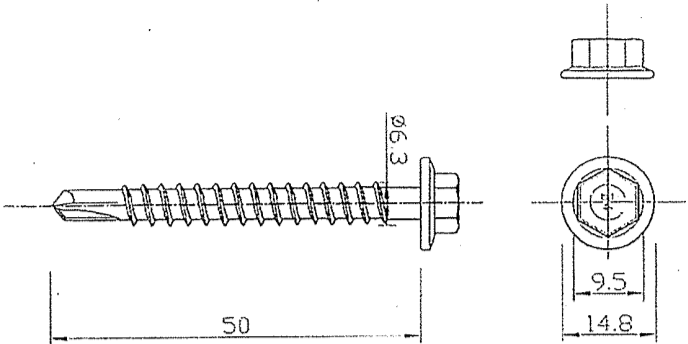

BREMICK BRA - CYCLONE WASHER / SEAL
ONE PIECE ALUMINIUM / EPDM CYCLONE WASHER

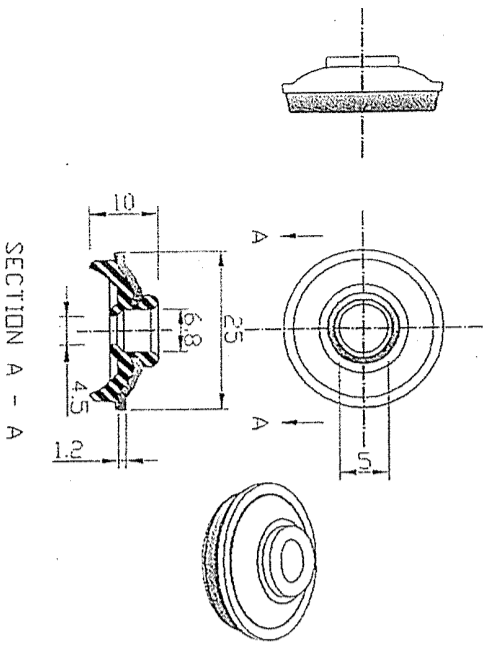

FASTENING:
BSL CUSTOM ORB®
0.42mm BMT G550 min.

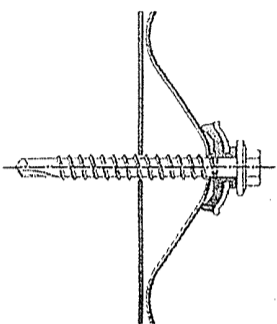

FASTENING TO:
STEEL PURLINS
1.5mm BMT min. G450 min.

FASTENING:
BSL TRIMDEK®
0.42mm BMT G550 MIN.

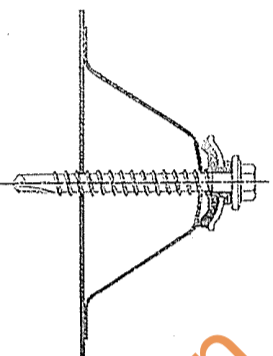

FASTENING TO:
STEEL PURLINS
1.5mm BMT min. G450 min.

FASTENING:
BSL SPANDEK®
0.42mm BMT G550 min.

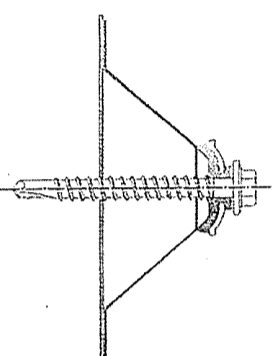

FASTENING TO:
STEEL PURLINS
1.5mm BMT min. G450 min.

CORRUGATED ROOFING PROFILE - BSL CUSTOM ORB®
FASTENER SPACINGS

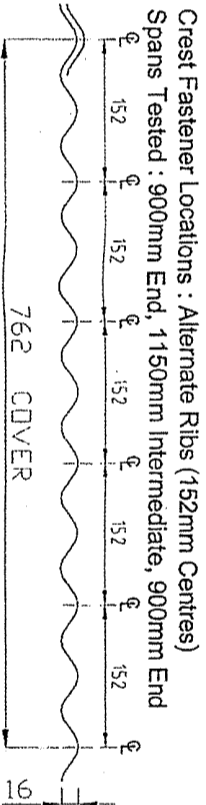

Supports	Crest Fixing	Side Lap Fixing
Steel Purlins G450	Bremick Self drilling for metal 14-10x50 - BRA Cyclone Assembly	Bremick Vortex™ Stitch M6.5-13x20 (900mm Centres min.)

SQUARE RIB ROOFING PROFILES - BSL TRIMDEK®
FASTENER SPACINGS

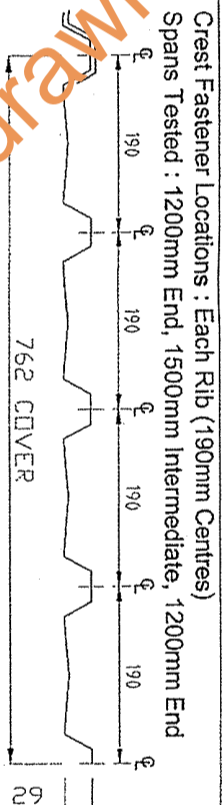

Supports	Crest Fixing	Side Lap Fixing
Steel Purlins G450	Bremick Self drilling for metal 14-10x50 - BRA Cyclone Assembly	Bremick Vortex™ Stitch M6.5-13x20 (900mm Centres min.)

SQUARE RIB ROOFING PROFILES - BSL SPANDEK®
FASTENER SPACINGS

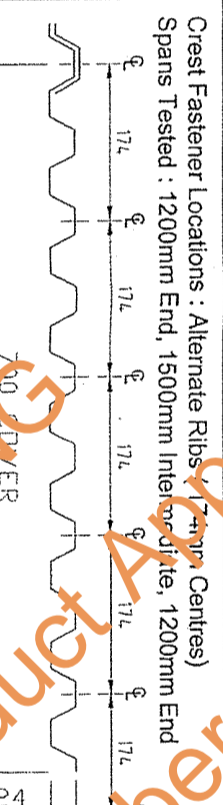

Supports	Crest Fixing	Side Lap Fixing
Steel Purlins G450	Bremick Self drilling for metal 14-10x50 - BRA Cyclone Assembly	Bremick Vortex™ Stitch M6.5-13x20 (900mm Centres min.)

Product Name
SDM BRA Cyclone Assembly

Product Description : Roofing Fasteners
SDM 14 - 10x50/65 - BRA
Cyclone Assembly

Manufacturer's Name
BREMICK FASTENERS Pty Ltd
www.bremick.com.au

Design Criteria
Fastener & support spacing to be controlled such that the maximum design loading per fastener or maximum design pressures do not exceed:

Table 1 : Strength Limit State Design Loads per Fastener

Roofing Profile	Test Load (kN)	C.O.V. (K ₁)	Design Load (kN)
Custom Orb®	0.88	1.30	0.68
Trimdek®	1.05	1.30	0.81
Spandek®	1.08	1.38	0.78

Table 2 : Strength Limit State Design Pressures

Roofing Profile	Test Pressure (kPa)	C.O.V. (K ₁)	Design Capacity (kPa)
Custom Orb®	5.36	1.30	4.12
Trimdek®	4.04	1.30	3.11
Spandek®	4.49	1.38	3.26

Limitations

This sheet confirms the structural adequacy of the roof sheeting assembly (sheeting, screw and washer) when correctly installed and does not extend to the capacity of the batten/purlin. Refer to the sheeting & batten manufacturers data for maximum support spacings. Axial withdrawal capacity for each fastener exceeds the 3.1kN requirements of AS3566.1.
Strength limit state fastener loads have been derived from the test pressures using simplified static analysis with the uniform pressure (load) distribution.

Accepted for Inclusion

DTCM ref: **M/167/01**

Chairman's Signature:

Chairman's Name: **STEVEN J. THURICH**

Date of Approval: **21/10/10** Expiry Date: **21/10/13**

Testing was undertaken at the University of Adelaide & BlueScope Lysaght Technology Centre. Tested and approved in accordance with the requirements of AS/NZS 1170.2 and the Building Code of Australia (BCA) 2008 Specifications B 1.2 for the Design of Buildings in cyclonic areas.

Test Certificate Numbers

Adelaide University: TR02, TR08 and TR12
BlueScope Lysaght Technology Centre: TR01, TR08 and TR12

**Design Engineers Certification

**Certifying Engineers Certification

Name: **Wahim Tapolinsky**
Rogo Number: **40255 & 41946**
Date: **6.9.10**
Signature: *[Signature]*

Name: **Trevor John**
NT Rogo Number: **12178 ES**
Date: **5.9.10**
Signature: *[Signature]*

New Expiry Date: **21/10/13**
Signature: *[Signature]*