

**ALLOWABLE ROOF SPANS FOR 0.53mm METLOK 500 ①
FIXED WITH 1.0mm THICK CYCLONE WASHERS ③**

REGIONAL BASIC
WIND SPEED = 57 m/sec ④

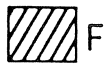

ISOMETRIC SHOWING
TYPICAL LOCAL PRESSURE
COEFFICIENTS (K)

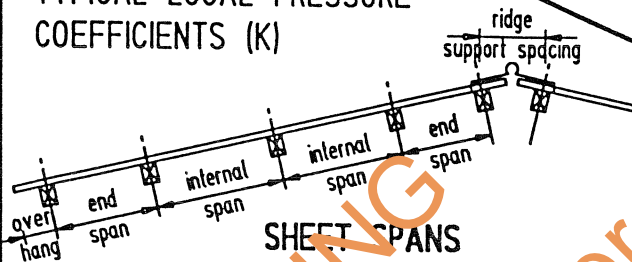
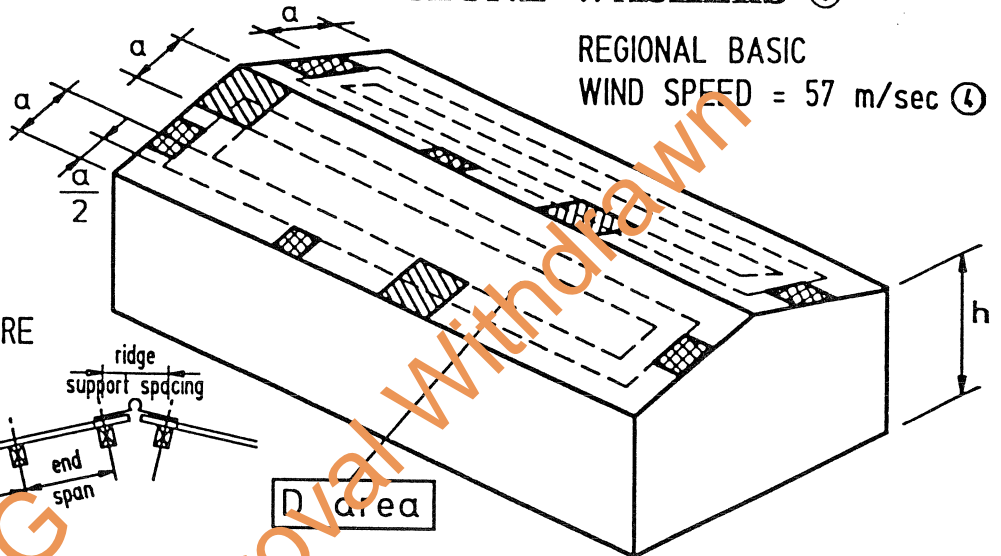

TABLE 1 . MAX. ALLOWABLE SPANS ⑤

	Terrain category Multiplier	Roof Area Notation	Fastener Frequency	Maximum End Span mm	Maximum Internal Span mm	Overhang	
						Maximum	Minimum
Every rib	0.95	D ② Pz = 2.8		1200	1500	Unsupported Overhangs 200mm Stiffened Overhangs 300mm	50mm for All Fixing Conditions
		F Pz = 1.6		1100	1300		
		G Pz = 4.4		900	1100		
	0.88	D Pz = 2.40		1300	1500		
		F Pz = 3.06		1200	1500		
		G Pz = 3.73		1000	1300		

NOTES :

1. 0.53mm total coated thickness (0.47mm base Zn/Al coated steel to AS1397 - G550

3 Refer to data sheet no. 2 for details of cyclone washer.

2. Vz = Vp M(z,cat) Ms Mt Mi where Ms = Mt = Mi = 1.0 and M(z,cat) = Terrain Category Multiplier.

4. Basic Wind Speed Vp = 57 m/sec.

5. Max. allowance spans derived from table 1 of data sheet 2.

$qz = 0.6Vz^2 \times 10^{-3}$

$pz = Cp qz$

Cp = Overall pressure coefficient

Cpe = +0.9 Cpi = +0.7

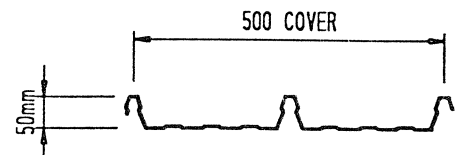

Sheeting Profile

MANUF'S NAME **METCLAD METAL ROOFING AND CLADDING PTY LTD**

FIXING OF Metlok 500

ADDRESS **LOT 1130 GEORGINA CR. PALMERSTON**
PHONE No. (089) 32 2077

On Buildings of Height up to 5m
IN THE DARWIN AREA



IRWIN, JOHNSTON & PARTNERS (N.T.) ENGINEERS PTY. LTD. CONSULTING ENGINEERS
82 SMYTH STREET, DARWIN 0801
TEL (089)819 011 FAX (089)814 010

DESIGN DATA SHEET 1

DEPT. OF LANDS AND HOUSING
BUILDING AUTHORITY BRANCH

DRAWING. NO.

M/114/7

CERTIFIED

M.I.E. AUST

APP'D

[Signature]

DATE 5-4-94