

### CYCLONE ASSEMBLY COMPONENTS

Comprising of self drilling screw & one piece cyclone washer  
**VORTEX CYCLONE UNIVERSAL SCREWS**  
 FOR FASTENING TO METAL BATTENS  
 M6.2-13x55mm & M6.2-13x25mm BRA  
 (HEAD MARKING B4V & B4 ONLY)  
 Screws are Class 4 in accordance with AS3566

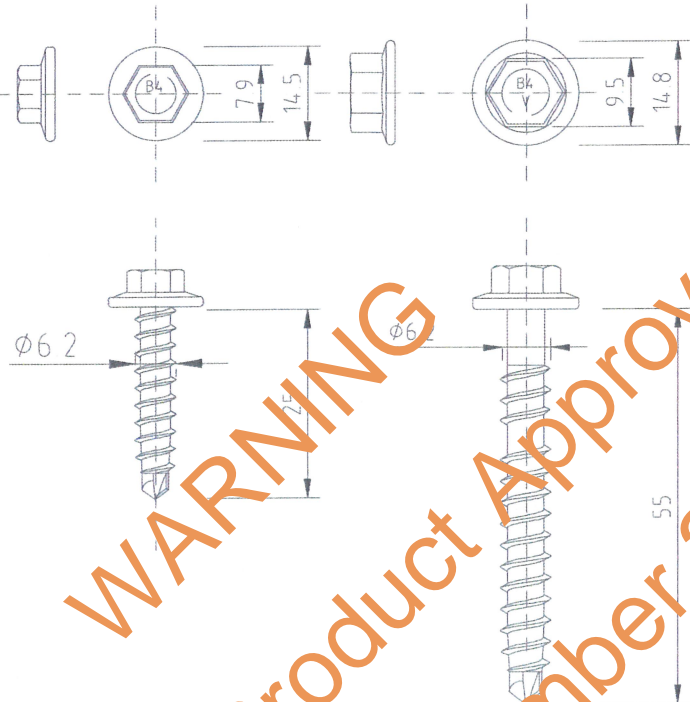

**BREMICK BRA - CYCLONE WASHER / SEAL**  
 ONE PIECE ALUMINIUM / EPDM CYCLONE WASHER

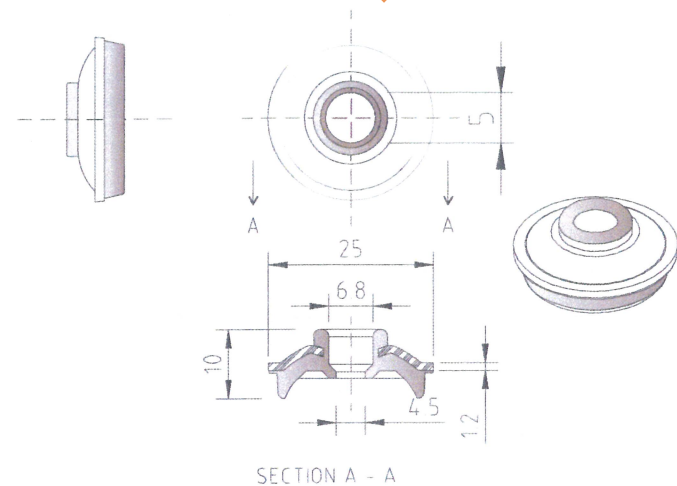

All dimensions mm ( nominal )

**FASTENING:**  
 VERSATILE BUILDINGS  
 6 RIB ROOFING PROFILE  
 0.42mm BMT min.  
 G550

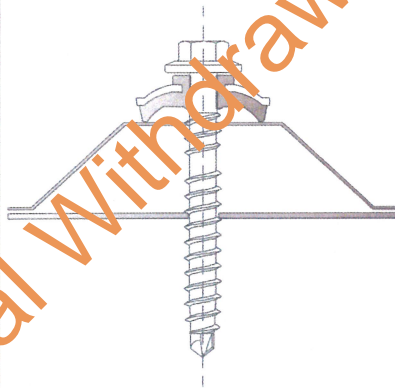

**FASTENING TO:**  
 METAL BATTENS  
 0.75mm BMT min.  
 G550 min.

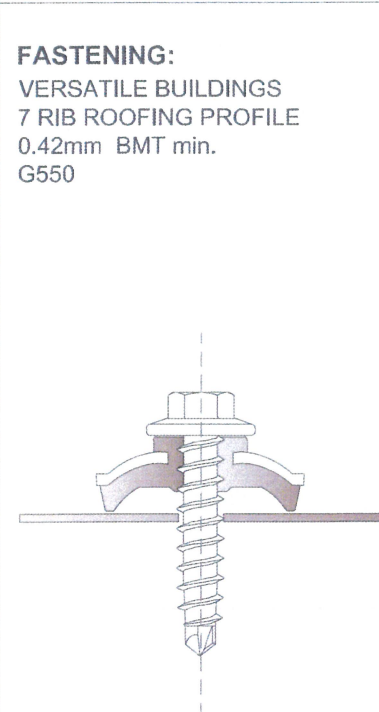

**FASTENING TO:**  
 METAL BATTENS  
 0.75mm BMT min.  
 G550 min.

### SQUARE RIB ROOFING PROFILE-VERSATILE BUILDINGS 6 RIB

#### FASTENER SPACINGS

Crest Fastener Locations : Each Rib (162mm Centres)  
 Spans Tested : 750mm End, 750mm Intermediate, 750mm End

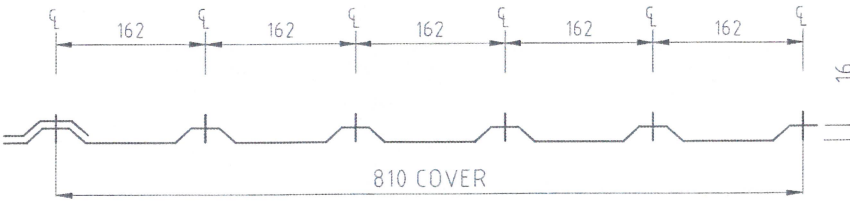

Supports	Crest Fixing	Side Lap Fixing
Metal Battens 0.75mm BMT min. G550 min.	Bremick Vortex™ Cyclone M6.2 -14x55 - BRA	Bremick HEX 10 -16x16 SL (900mm Centres min.)

### SQUARE RIB ROOFING PROFILE-VERSATILE BUILDINGS 7 RIB

#### FASTENER SPACINGS

Pan Fastener Locations : Each Pan Centre (162mm Centres)  
 Spans Tested : 750mm End, 750mm Intermediate, 750mm End

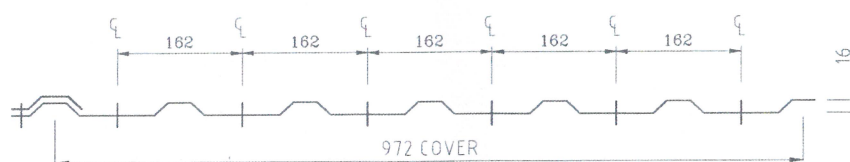

( Pan fixing may not meet the performance provisions for water ingress of the BCA )

Supports	Crest Fixing	Side Lap Fixing
Metal Battens 0.75mm BMT min. G550 min.	Bremick Vortex™ Cyclone M6.2 -13x25 - BRA	Bremick HEX 10 -16 x16 SL (900mm Centres min.)

Product Name

**VORTEX™ CYCLONE-Cyclone Assembly**

Product Description : Roofing Fasteners  
**M6.2 - 13x55 & M6.2 - 13x25 - BRA  
 Cyclone Assembly**

Manufacturer's Name: **BREMICK Pty Ltd**  
 F1, 62 Maddox Street  
 Alexandria NSW 2015  
 Ph: 02 8332 1501  
 Email: sales@bremick.com.au

#### Design Criteria

Fastener & support spacing to be controlled such that the maximum design loading per fastener or maximum design pressures do not exceed:

Table 1 : Strength Limit State Design Loads per Fastener

Roofing Profile	Test Load ( kN )	C.O.V. ( K )	Design Load ( kN )
Versatile 6 Rib*	0.96	1.38	0.70
Versatile 7 Rib*	0.91	1.30	0.70

Table 2 : Strength Limit State Design Pressures

Roofing Profile	Test Pressure ( kPa )	C.O.V. ( K )	Design Capacity ( kPa )
Versatile 6 Rib*	7.20	1.38	5.22
Versatile 7 Rib*	6.79	1.30	5.22

Notes:

+ Rib fastened 0.42mm BMT, \* Pan fastened 0.35mm BMT

#### Limitations

This sheet confirms the structural adequacy of the roof sheeting assembly ( sheeting, screw and washer ) when correctly installed and does not extend to the capacity of the batten/purlin. Refer to the sheeting & batten manufacturers data for maximum support spacings. Axial withdrawal capacity for each fastener exceeds the 3.1kN requirements of AS3566.1: 2002 - Self-drilling screws for the building and construction industries. General requirements and mechanical properties. Strength limit state fastener loads have been derived from the test pressures using simplified static analysis with the uniform pressure (load) distribution.

#### Accepted for Inclusion

DTCM ref: M/665/01

Chairman's Signature:

Chairman's Name:

STEVEN J. EURLICH

Date of Approval: 10.12.2015 Expiry Date: 09.12.2020

Notes covering basis of DTC ( Relevant tests reports etc.)

Testing was undertaken at the James Cook University. Tested and approved in accordance with the requirements of AS/NZS 1170.2 : 2011 - Structural design actions - Wind actions and the Building Code of Australia ( BCA ) 2015 Specifications B1.2 for the design of buildings in cyclonic areas.

#### Test Certificate Numbers

James Cook University : TS666 (parts a & b) - 16/8/2007

\*Checking Engineers Certification

Name: **RACHAEL ZELNER**  
 Registration Number: **NPER 11734**  
 Date: **8/12/15**  
 Signature: **Rzelner**

\*registered as a structural engineer in Australia

\*Certifying Engineers Certification

Name: **TREVOR JOHN**  
 NT Registration Number: **127185**  
 Date: **9.12.15**  
 Signature: **TJ**

\*registered as a structural engineer in the Northern Territory