

SOLAHART
 LOT 1546 WINNELLIE RD.
 P.O. BOX 37094
 WINNELLIE 0821
 TEL: (089) 470274
 FAX: (089) 471944

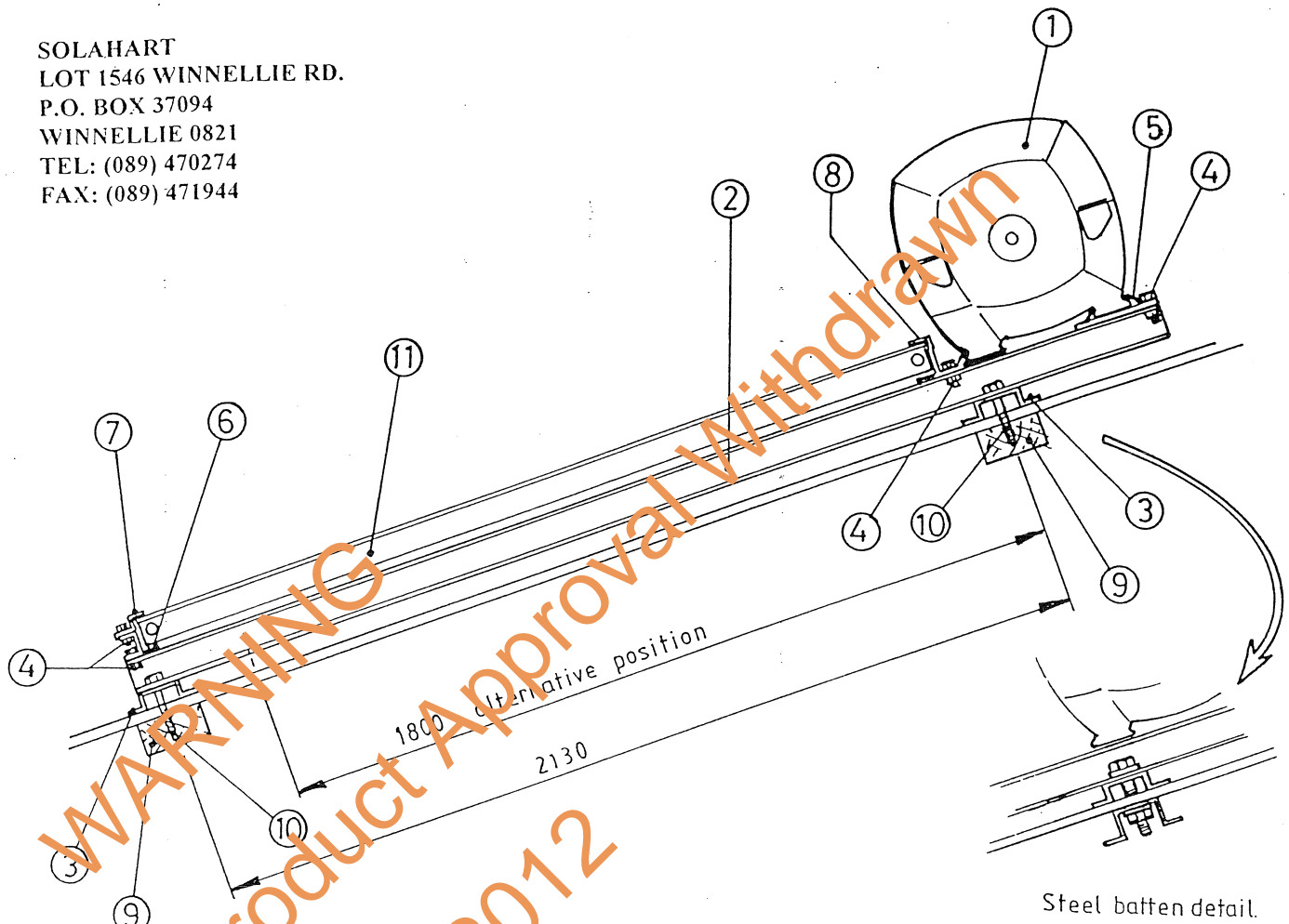

- STORAGE CYLINDER 300 OR 180 LITRES.
- 2 CHANNEL SECTION 62 x 37 x 2 (P/No. 1909)
 - 3 TOP HAT BASE SECTION 104 x 25 x 2 (P/No. 1822)
 - 4 M8 x 20 BOLD NUT AND WASHER.
 - 5 ALUMINIUM TANK CLAMP 108 x 50 x 3 (P/No. 1832)
 - 6 COLLECTOR RAIL AL. EXT. 46 x 50 x 24-1.123 kg/m (P/No.1840)
 - 7 COLLECTOR CLAMP AL. EXT. 42 x 26 x 4 (P/No. 1832)
 - 8 TANK/COLLECTOR RAIL AL.EXT. 105 x 88-1.42kg/m (P/No. 1824)
 - 9 75 x 50 H.WOOD OR APPROVED STEEL BATTENS (REF. NOTE 2) FIXED IN ACC. WITH NORTHERN TERRITORY DTC MANUAL.
 - 10 USE No. 14 x 55mm TYPE 17 HWF TEK SCREWS FOR FIXING TO TIMBER BATTENS (PENETRATION 35mm IN TIMBER) AND M8 BOLTS WITH 20mm WASHERS UNDER HEAD AND NUT FOR FIXING TO STEEL BATTENS, OR M12 THREADED ROD (USED FOR "CLEAR OF ROOF INSTALLATION " 4 TOP, 4 BOTTOM, 8 TOTAL).
 - 11 COLLECTOR (1020x1935 PER 1)

NOTES:

- 1 TRUSSES OR RAFTERS SPACED AT MAX. 1200 CTRS.
- 2 ITEM 9 BATTENS TO BE CONTINUOUS OVER NOT LESS THAN 3 TRUSSES
- 3 CLEAR OF ROOF INSTALLATION MUST BE USED WITH CONCRETE TILED ROOFS. AS PER DTC M/503/14-16.
- 4 ROOF STRUCTURE MUST BE DESIGNED TO ACCEPT THE WEIGHT OF THE PANELS AND TANK (TOTAL 490 kg 300L UNIT)
- 5 LOCATE UNIT TOWARDS CENTRE OF ROOF AREA WHERE POSSIBLE.
- 6 DESIGN CRITERIA:
 BASIC REGIONAL DESIGN WIND VELOCITY = 57 m/s
 TERRAIN CATEGORY 2. Hz = 10 m
- 7 ITEM 10 TO BE LOCATED 50mm FROM EACH SIDE OF ITEM 2 ON CENTRE LINE.
- 8 ALL BOLTS AND TEK SCREWS TO BE GALVANISED

Colless & O'Neill Pty. Ltd. Consulting Engineers Darwin N.T. (089) 819644	SOLAHART SOLAR WATER HEATERS 300L types J&L, 180L type L&J	
AMENDMENT B	DESIGN DATA SHEET	DWG No
Certified <i>[Signature]</i>	DARWIN CYCLONE AREA	M/507/1
Date 5-7-95	APP'D <i>[Signature]</i> DATE 14-7-95	