

ITEM '1'
PART N°: 4784

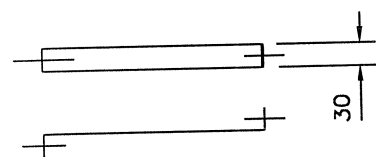

ITEM '2'
PART N°: 2821

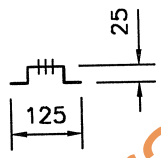
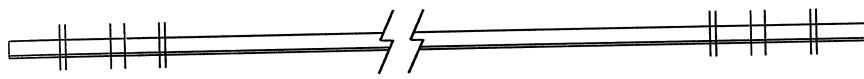
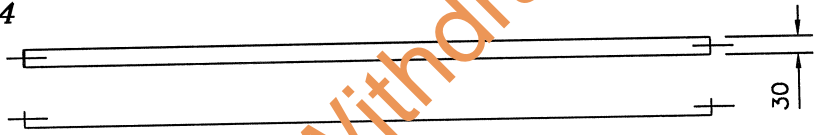

ITEM '3'
PART N°: 2822

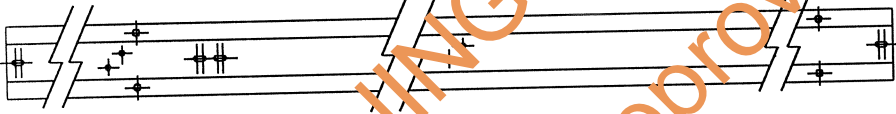

ITEM '4'
PART N°: 4198

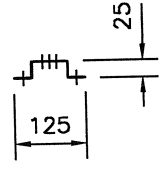

ITEM '5'
PART N°: 5062

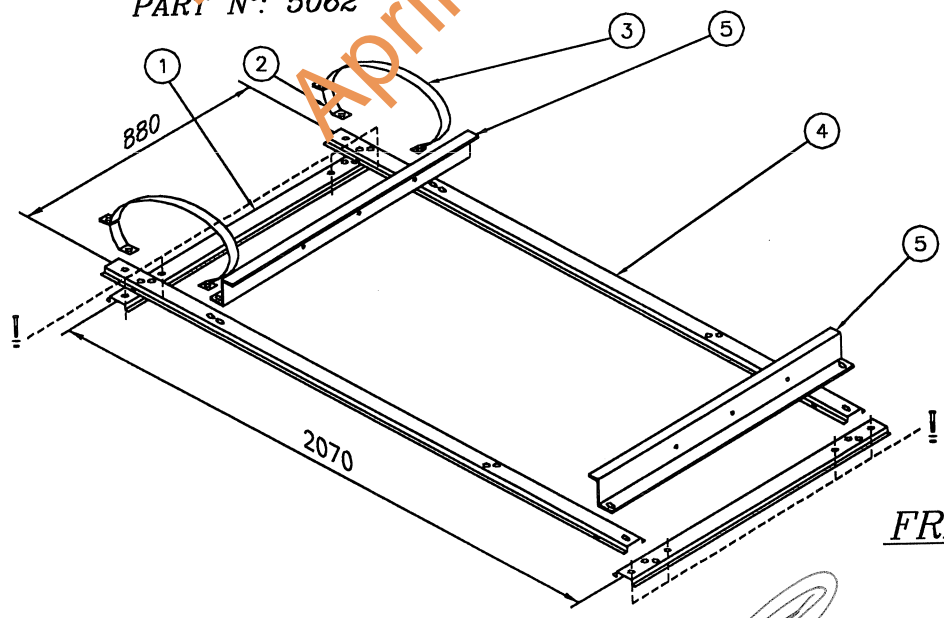

(Fixings to roof)

FRAME ASSEMBLY
N.T.S.

APPROVED FOR INCLUSION IN THE N.T. DEEMED TO COMPLY BY BAC  DATE 16/11/99

EDWARDS ENERGY SYSTEMS PTY. LTD.
109 VULCAN ROAD, CANNING VALE, WESTERN AUSTRALIA 6155 .
PH: (08) 9334 4222 FAX: (08) 9334 4200
ALL INTELLECTUAL PROPERTY IN THIS DESIGN INCLUDING
ANY PATENT, PATENT APPLICATION AND/OR DESIGN
REGISTRATION AND/OR COPYRIGHT ARE THE PROPERTY
OF EDWARDS ENERGY SYSTEMS PTY LTD.A.C.N. 008 676 613

L180 CYCLONE FRAME COMPONENTS
STANDARD N.T.

DESIGN DATA SHEET

COLLESS AND O'NEILL PTY LTD
CONSULTING CIVIL AND STRUCTURAL ENGINEERS
84 Woods Street, DARWIN, N.T. 0800
Ph (08) 8981 9644 ACN 009 622 968
CERTIFIED:  DATE: 29/9/99

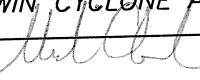
DARWIN, CYCLONE AREA
APP'D.: 
DATE: 29.9.99

OUR REFERENCE:
4515
REVISION: 2

DRAWING No.:
M/510/2