

Was GPS as 349733/7853005
Now 350354/7852336

1.8 km North from pump station
to 7122 and 7127A
350375 A
7854170 A

GPS location
way off in
direction
seems
incorrect

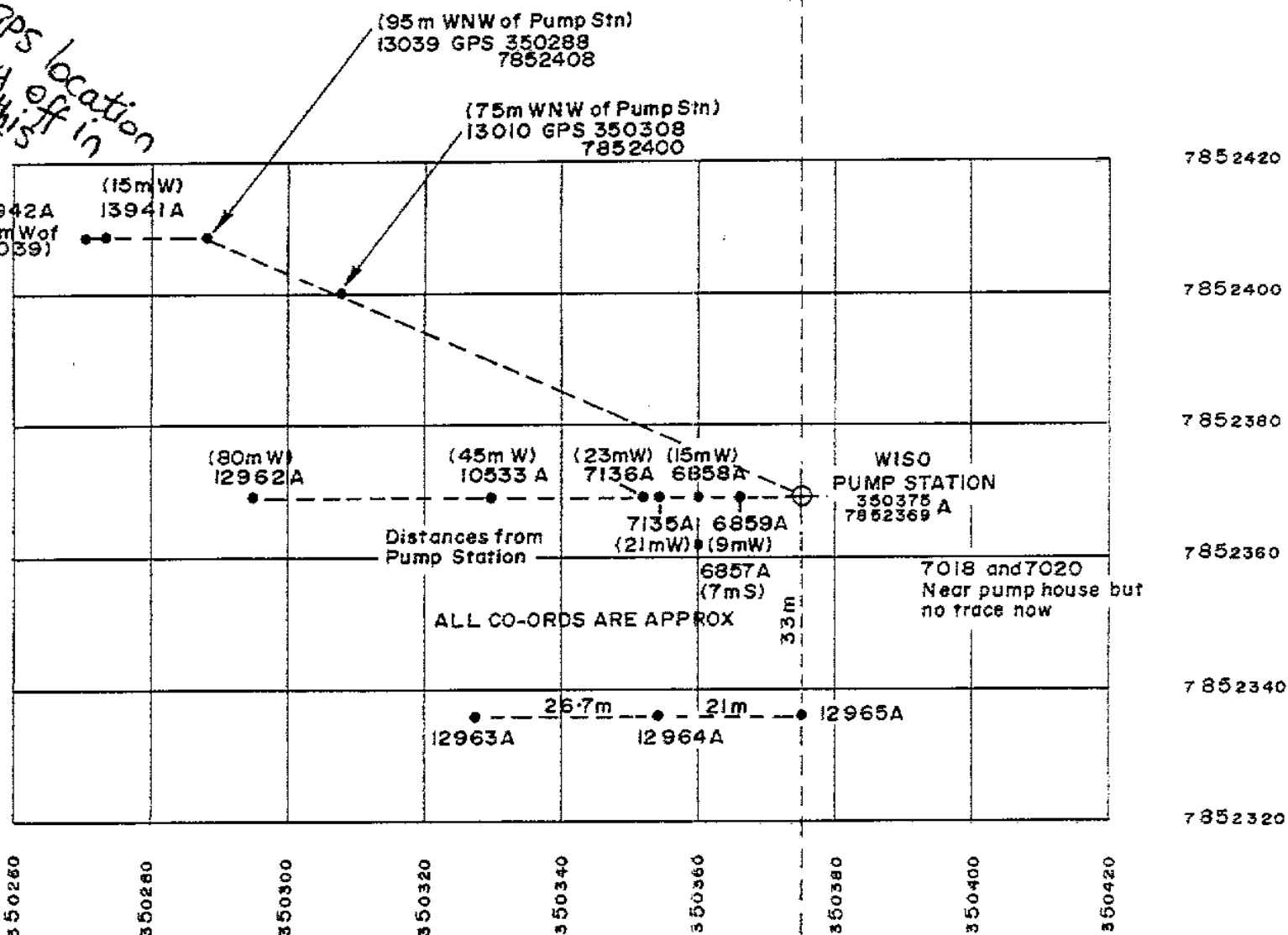

NOTE: GRID IS BASED ON GPS COORDS
OF RN 13039 AND RN 13010

Vax, Map + BD. File
amended March 1992

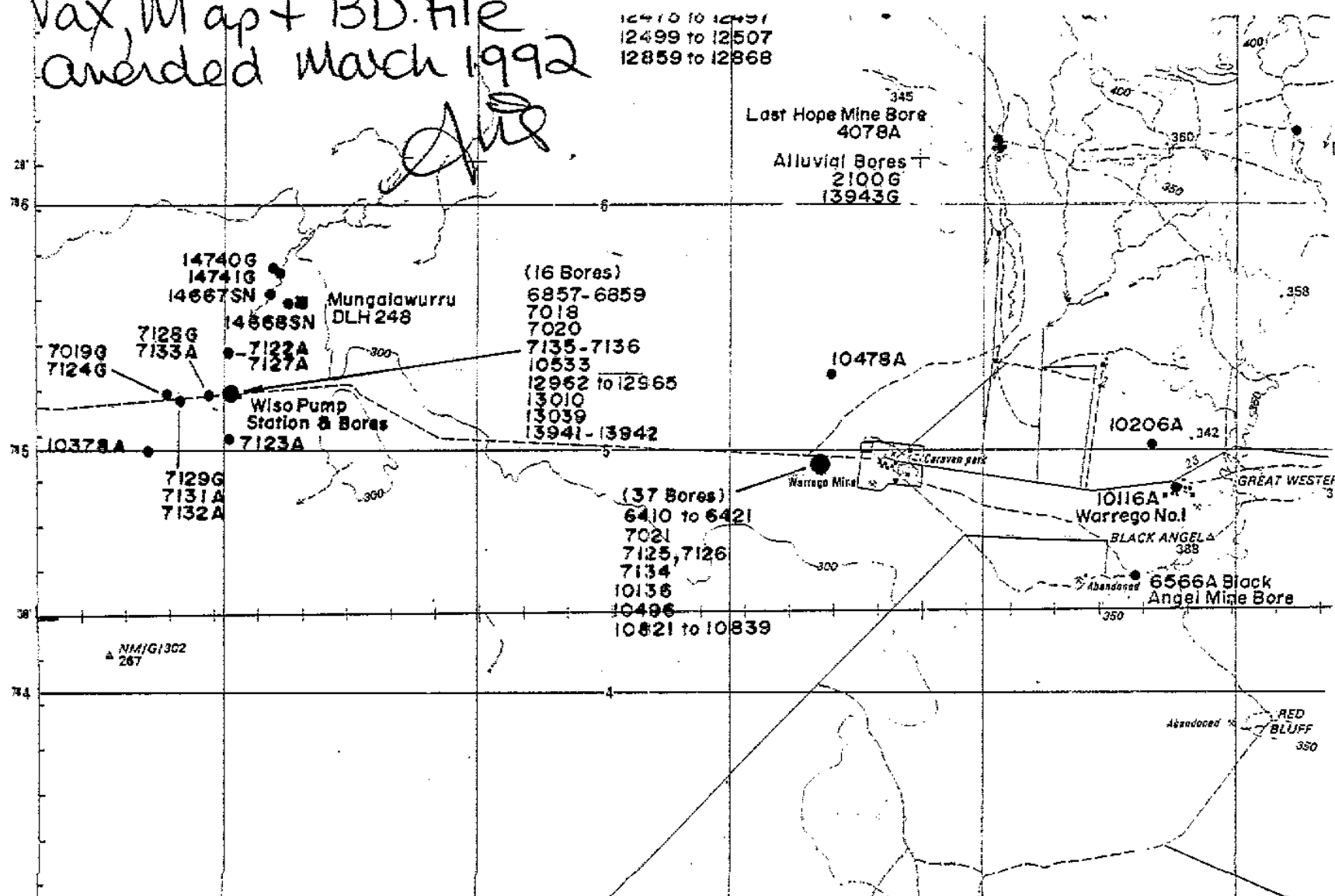

BORE DATA - MASTER INDEX - COMPUTER INPUT SHEET

Condition ABD POOL PUMP TESTRN 12964 INDEX 40/657NAME (30) W3/80 WISO N°10LOCATION (30) 21M WEST OF WISO RN12965CADASTRAL (35) PHILLIP CREEK PL 831S/NAV GPS/TRANS EL H 24 V 46 CT NO 4 TIME 1630 3005AMS ZONE 53 EASTING 349865 NORTHING 785367LATITUDE 19° 24' 60S 692 LONGITUDE 133° 34' 207 131LOCATION PRECISION 4AWRC BASIN NUMBER 1209 (4)OLD IMP GRID SE53/14 3500-8520 1:250000 TENNANT CREEKNEW IMP GRID COMP/CONVERSION 121-566DISCHARGE LPS. DEPTH SAMPLED METHOD SAMPLE NO. TIME HRS. DATE TEMP PH CONDUCTIVITY OTHER T-DEPTH IF MEASURED 50.9676 METERSSWL IF MEASURED 50.96 METERS- TIME 1255 DATE 9-11-89CASING/WELL ABOVE GROUND BY 115 M BORES IN AREA BEING PUMPED @ TIME SWL TAKENBORE EQUIPPED WITH 13" GALL SURFACE CASING WITH 2" 10 STEEL LINER
CONCRETE BLOCK AROUND CASINGCOMMENTS: NOT CAPED, INFO FROM WARREGO ABOUT PUMP TEST
HOLE BRIDGED @ 50-96MTAG LOCATION: ON SIDE OF CASINGUSED FOR: NIL POOR SUPPLY WHEN PUMP TESTEDINSPECTING OFFICER R Marks DATE 9-11-89

WATER ANALYSIS

Department of Transport & Works
Water Division, Darwin NT.

WR 4/IA

Bottle No.
ZT87

Laboratory Register No

81/0491

13

Date received in Laboratory

27/4/81

Time of sampling

Date of sampling

12/12/80

LOCATION AND DETAILS

WARREGO NO. 3 R/N 12964

R.S.P. 317

Proposed water use:- Domestic, Stock, Irrigation, other [specify]

ANALYSIS-PHYSICAL

<input type="checkbox"/> pH	7.7	<input type="checkbox"/> Colour [Hazen units]	
<input type="checkbox"/> Specific conductance [microsiemens/cm at 25° C]	3680	<input type="checkbox"/> Turbidity [NTU's]	
<input checked="" type="checkbox"/> Total dissolved solids [mg/l - by evaporation at 180° C]	1930	<input type="checkbox"/> Suspended solids [mg/l]	

ANALYSIS-CHEMICAL [mg/l]

<input type="checkbox"/> Sodium, Na	486	<input checked="" type="checkbox"/> Chloride, Cl	630
<input type="checkbox"/> Potassium, K	84	<input type="checkbox"/> Sulphate, SO ₄	390
<input type="checkbox"/> Calcium, Ca	62	<input type="checkbox"/> Nitrate, NO ₃	32
<input type="checkbox"/> Magnesium, Mg	71	<input type="checkbox"/> Bicarbonate, HCO ₃	403
<input type="checkbox"/> Total Hardness [as CaCO ₃]	446	<input type="checkbox"/> Carbonate, CO ₃	
<input type="checkbox"/> Total Alkalinity [as CaCO ₃]	331	<input checked="" type="checkbox"/> Fluoride, F	2.1
<input checked="" type="checkbox"/> Iron, [total] Fe	1.8	<input type="checkbox"/> Orthophosphate, PO ₄	
<input type="checkbox"/> Silica, SiO ₂	34	<input checked="" type="checkbox"/> NaCl [calc. from chloride]	1040

ANALYSIS-ADDITIONAL [mg/l]

<input type="checkbox"/> Copper, Cu	<input type="checkbox"/> Lead, Pb	<input type="checkbox"/> Arsenic, As
<input type="checkbox"/> Manganese, Mn	<input type="checkbox"/> Zinc, Zn	<input type="checkbox"/> Cadmium, Cd
<input type="checkbox"/>	<input type="checkbox"/>	<input type="checkbox"/>

Analysed By : K. Cooper

Date 19 5 81

REMARKS

The sample as analysed is considered suitable for :-

Drinking water —

☒ Yes/No

Stock watering —

☒ Yes/No

Irrigation —

☐ Yes/No

Others [specify]

☐ Yes/No

WATER INVESTIGATIONS UNIT

ALICE SPRINGS

26 JUN 1981

DEPT. OF TRANSPORT & WORKS

Boxes marked thus ☒ indicate levels considered undesirable for drinking water by the Northern Territory
Department of Health.

Note :- Advice and Water quality information can be obtained by contacting the Senior Engineer
Water Quality, Darwin Phone 896072



RN012964

Regulation 8

THE NORTHERN TERRITORY OF AUSTRALIA

Control of Waters Ordinance

FINAL STATEMENT OF BORE

From	To	Description of Strata	Name of Bore:			
			W3/80			
			Name of Property:			
			WARREGO			
			Description of Property:			
			MINE			
			Name of Owner:			
			PEKO WALLSEND			
			Name of Contractor:			
			GOREY & COLE DRILLERS			
			Name of Driller:			
			BRUCE VILLIERS			
			Date of commencement:			
			10.12.80			
			Date of Completion:			
			12.12.80			
			Total Depth:			
			91m			
			Particulars of Casing:			
			76m x 8"			
			Particulars of Perforations or Screens:			
			4.5m x perfs			
			Water	1st Supply	2nd Supply	3rd Supply
			Struck at	53m		
			Standing Water level	not recorded		
			Yield	1/s	1.514	
			Duration of Test	2 hrs		
			Water level During Test			
			Quality: Good, Fair, Bad	FAIR		

Location of Bore: (or supply sketch on back hereof) -

150ft kilometres

N NE of (b) SOUTH WEST OF WISO

S SE PUMPING STN

E NW

W SW

(a) Circle appropriate direction.

(b) Use known point such as existing bore, homestead, outstation etc.

Additional information of interest about the bore -

Map No: SE 53-14

Grid Reference: 3500 8520 AMG

Samples of strata and water supplies

Will be*

Left at the following trading place:

M.R.B. ALICE SPRINGS

..... (Signature)

* Strike out which does not apply.

For office only:

Plotted 6/3/81 52990

WATER ANALYSIS

Department of Transport & Works
Water Division, Darwin NT.

WR 4/1A

Bottle No.
ZT87

Laboratory Register No

81/0491

Date received in Laboratory

27/4/81

Time of sampling

Date of sampling

12/12/80

LOCATION AND DETAILS

WARREGO NO. 3 R/N 12964

R.S.P. 317

Proposed water use:- Domestic, Stock, Irrigation, other [specify]

ANALYSIS-PHYSICAL

<input type="checkbox"/> pH	7.7	<input type="checkbox"/> Colour [Hazen units]	
<input type="checkbox"/> Specific conductance [microsiemens/cm at 25° C]	3680	<input type="checkbox"/> Turbidity [NTU's]	
<input checked="" type="checkbox"/> Total dissolved solids [mg/l - by evaporation at 180° C]	1930	<input type="checkbox"/> Suspended solids [mg/l]	

ANALYSIS-CHEMICAL [mg/ l]

<input type="checkbox"/> Sodium, Na	486	<input checked="" type="checkbox"/> Chloride, Cl	630
<input type="checkbox"/> Potassium, K	84	<input type="checkbox"/> Sulphate, SO ₄	390
<input type="checkbox"/> Calcium, Ca	62	<input type="checkbox"/> Nitrate, NO ₃	32
<input type="checkbox"/> Magnesium, Mg	71	<input type="checkbox"/> Bicarbonate, HCO ₃	403
<input type="checkbox"/> Total Hardness [as CaCO ₃]	446	<input type="checkbox"/> Carbonate, CO ₃	
<input type="checkbox"/> Total Alkalinity [as CaCO ₃]	331	<input checked="" type="checkbox"/> Fluoride, F	2.1
<input checked="" type="checkbox"/> Iron, [total] Fe	1.8	<input type="checkbox"/> Orthophosphate, PO ₄	
<input type="checkbox"/> Silica, SiO ₂	34	<input checked="" type="checkbox"/> NaCl [calc. from chloride]	1040

ANALYSIS-ADDITIONAL [mg/ l]

<input type="checkbox"/> Copper, Cu	<input type="checkbox"/> Lead, Pb	<input type="checkbox"/> Arsenic, As
<input type="checkbox"/> Manganese, Mn	<input type="checkbox"/> Zinc, Zn	<input type="checkbox"/> Cadmium, Cd
<input type="checkbox"/>	<input type="checkbox"/>	<input type="checkbox"/>

Analysed By: K. Cooper

Date 19 5 81

REMARKS

The sample as analysed is considered suitable for :-

Drinking water — ☒ Yes/NoStock watering — ☒ Yes/NoIrrigation — ☐ Yes/No

Others [specify]

☐ Yes/NoBoxes marked thus ☒ indicate levels considered undesirable for drinking water by the Northern Territory
Department of Health.Note :- Advice and Water quality information can be obtained by contacting the Senior Engineer
Water Quality, Darwin Phone 896072