

LEGEND

— W —	WATER LINE
— WW —	WATER RISING MAIN
— S —	SEWER LINE
— SS —	SEWER RISING MAIN
— LV —	ELECTRICITY (LV)
— HV —	ELECTRICITY (HV)
■	APPROX POSITION
■	BUILDING CONSTRUCTED SINCE
■	DATE OF PHOTOGRAPHY
///	LAND EXCLUDED FROM DEVELOPMENT
*	* NOTE EXPLAINING EXCLUSION
⊠	BUILDING BEYOND ECONOMIC REPAIR

NOTE: The position of all services is approximate only.

CORRECTIONS/UPDATES

LAND USE PLANNING
Indigenous Infrastructure Unit
Dept of Planning and Infrastructure
GPO Box 1680 DARWIN NT 0801
TEL: (08) 8924 7765 FAX: (08) 8924 7773

LAND AVAILABLE FOR FUTURE DEVELOPMENT

○	←	SERVICED SITE 50m (diam.)
WS RE	→	Denotes Service Required W = WATER / S = SEWER R = ROAD / E = ELECTRICITY

BEACH

1

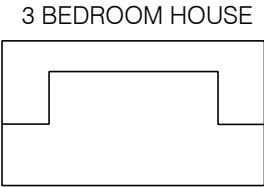

ELEVATED
WATER
TANK

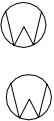

WATER
STORAGE
TANKS

2



CAMP

MANINGRIDA 32km

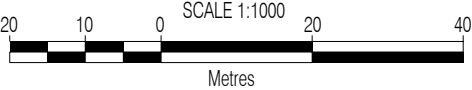

PREPARED BY DEPARTMENT OF PLANNING AND INFRASTRUCTURE
© NORTHERN TERRITORY OF AUSTRALIA

REFERENCE DRAWINGS

SURVEYED :

AMENDMENTS			
No.	Date	Description	Authorised
1	Nov 02	Created from sketch	P. Siebert
		Plan last updated by PSX on the 22/11/2002	

MANINGRIDA
COUNCIL
INC

COMMUNITY MAP
NADILMUK
(NADILMOK)
(NDJUDDA POINT)
886